



Marking to ATEX 94/9/EC Directive: Ex II 2 G Ex d IIC T6 or T5 Gb / II 2 D Ex tb IIIC T80°C or T95°C Db IP6X

Zone: 1, 2, 21, 22 , Gas Group IIC

Compliance with: EN 60079-0:2009 (IEC 60079-0:2007), EN/IEC 60079-1:2007,

EN 60079-31:2009, IEC 60079-31:2008

EC Uype Examination Certificate: ISSeP 10 ATEX 017X



FEATURES

Application: For operation of motors and a wide range of electrical equipments.

Enclosure: Copper free aluminium alloy suitable for petroleum and marine locations. Cast iron on request.

Range: Emergency stop, start - stop, rotary switch, signal lamp, ammeter or other components can be used in any configuration to suit various requirements. Type of enclosures used is from GUBST (Exd IIC) range.

IP rating: IP65 to IEC 529 by application of an approved non-hardening grease for added resistance to ingress of dust and moisture. IP66 & IP67 supplied on request.

Cable entry: ISO 965.1 metric as standard. NPT or other threads supplied on request.

Earthing: Standard M6 internal and external earth screws. Larger sizes on request.

Finish: Electrostatic powder coated or two pack epoxy paint.



OPTIONS

Stainless steel screws.

Cable gland or stopping plug.

Larger size than M6 earth screw.

Cast iron enclosure.

نور محور فارس
تولید کننده تجهیزات الکتریکی ضد انفجار
NM SWITCHGEAR
Explosion Proof Electrical Supplies



Typical examples of Exd IIC Control Stations

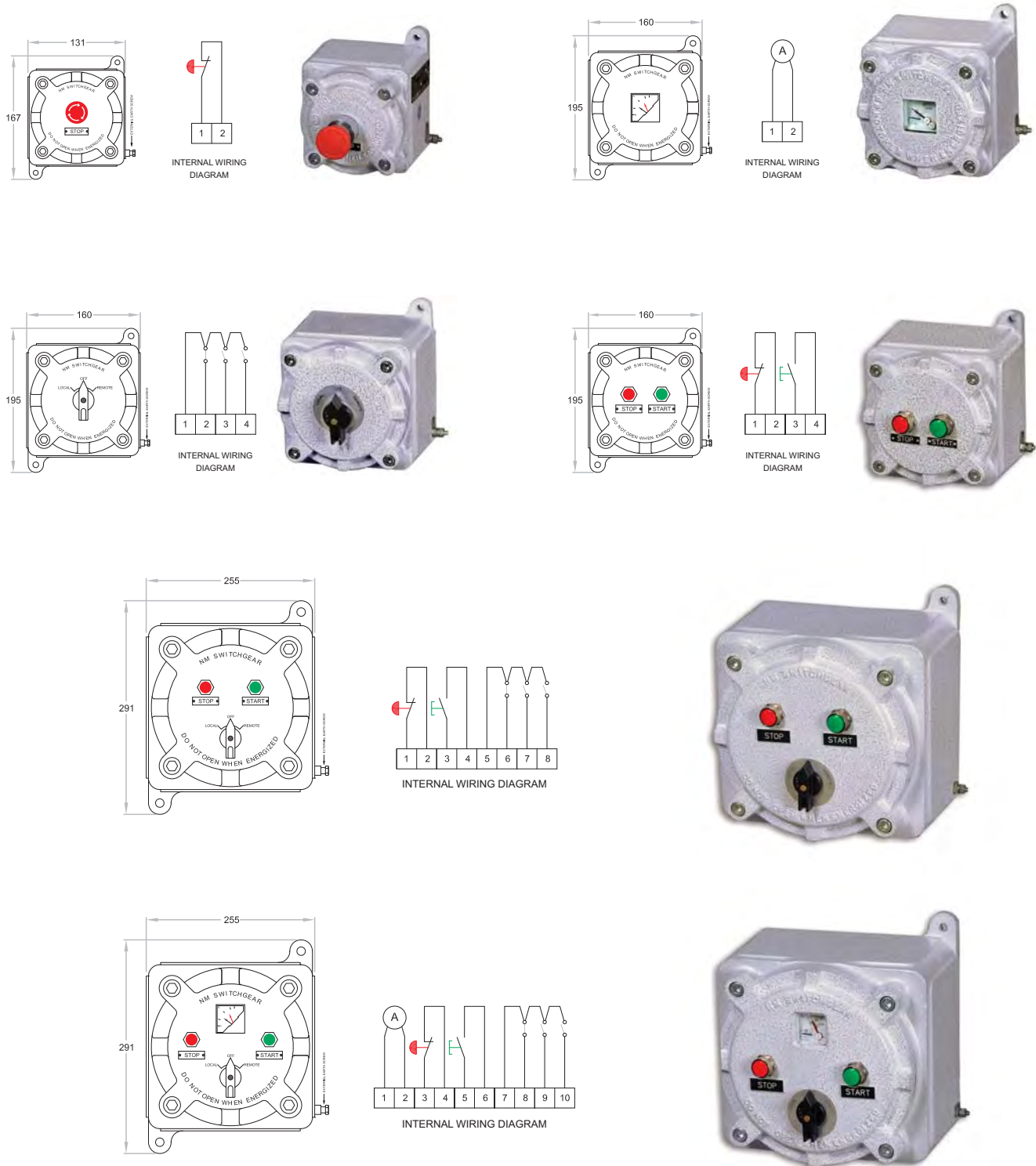

GUBSC.. Control and Signalling Boxes

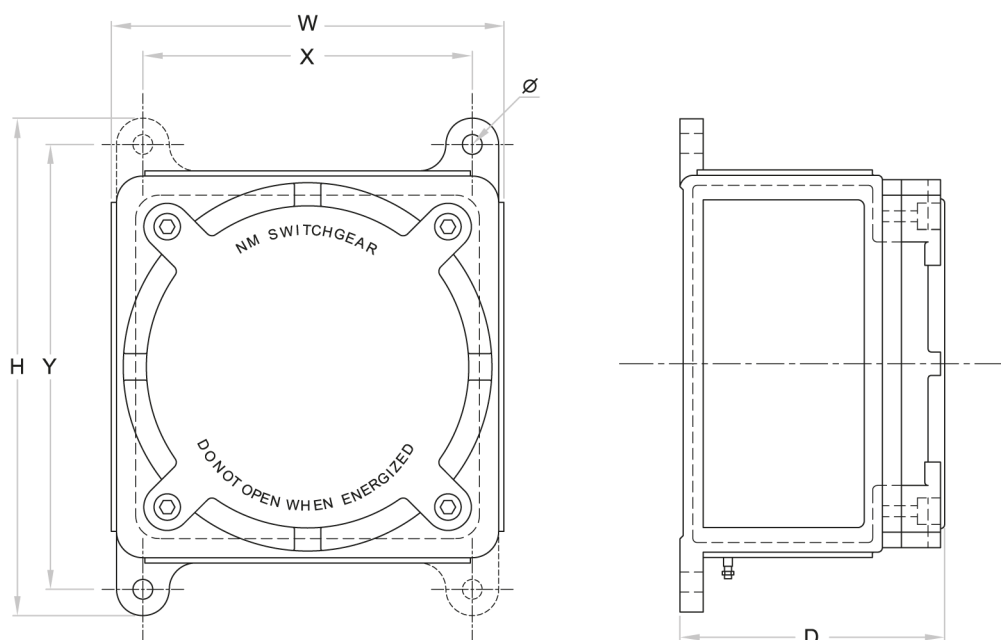

Table 1. GUBSC range of enclosures and dimensions (in mm)

ENCLOSURE	OVERALL DIMENSIONS			MOUNTING DETAILS				WEIGHT KGS.
	CAT NO.	W	H	D	X	Y	Ø	NO. OF LUGS
GUBSC1	131	167	125	97	151	8	2	2.7
GUBSC2	160	195	135	125	174	8	2	3.8
GUBSC3	181	220	138	150	193	8	2	4.2
GUBSC4	255	291	174	217	260	10	2	9.8
GUBSC5	318	378	245	275	337	14	4	19.2

Dimensions shown are within manufacturing tolerances