



Marking to ATEX 94/9/EC Directive: Ex II 2 G Ex d IIC T4 or T3 Gb / II 2 D Ex tb IIIC T126°C or T141°C Db IP66

Zone: 1, 2, 21, 22 , Gas Group IIC

Compliance with: IEC 60079-0 : 2007, IEC 60079-1 : 2007, IEC 60079-31 : 2008

EC Type Examination Certificate: ISSeP 09 ATEX 012



FEATURES

- Enclosure:** Copper free aluminium alloy suitable for petroleum and marine locations.
- Glass:** Heat and impact resistant tempered glass sealed onto a threaded metal base.
- Lamp holder:** E40, for up to 400W discharge lamps or 500W incandescent and blended lamps.
- Power unit:** For discharge lamps a separate enclosure is used to accommodate ballast, starter (or capacitor), to avoid direct heat from the lamp damaging these components and give much longer service life.
- Reflector:** Built in aluminium reflector supplied as standard.
- IP rating:** IP66 to IEC 529 / EN 60529.
- Installation:** Designed to be installed and rotate in any horizontal or vertical direction.
- Cable entry:** ISO 965.1 metric as standard. NPT or other threads supplied on request.
- Earthing:** Standard M6 internal and external earth screws.
- Finish:** Electrostatic powder coated or two pack epoxy paint.



OPTIONS

Cable gland.

Lamp.

For 250 watt only: power unit mounted on floodlight enclosure.

نور محور فارس
تولید کننده تجهیزات الکتریکی ضد انفجار
NM SWITCHGEAR
Explosion Proof Electrical Supplies



NMFL.. Installation Types and Accessories

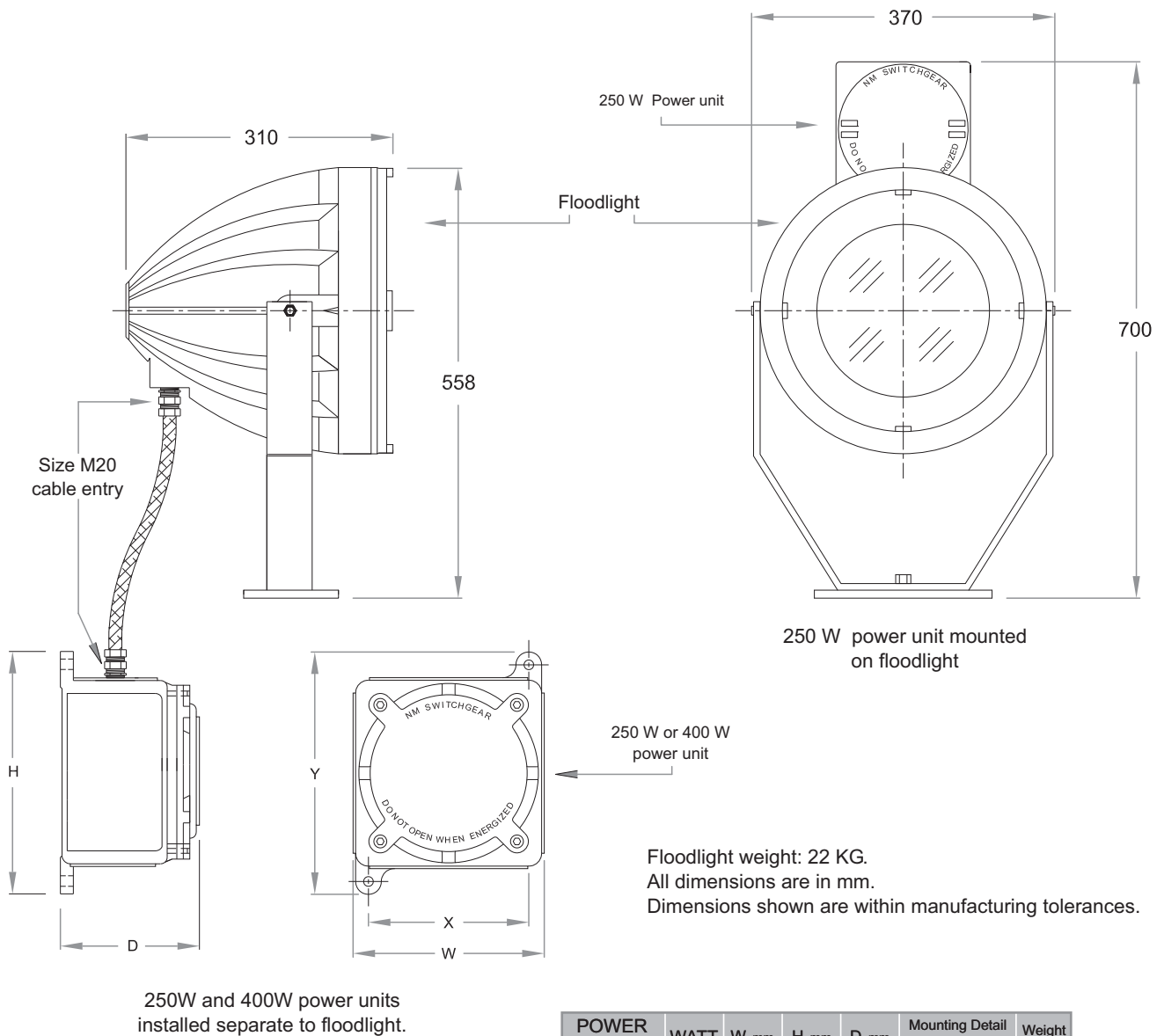

Floodlight weight: 22 KG.
All dimensions are in mm.
Dimensions shown are within manufacturing tolerances.

POWER UNIT	WATT	W mm	H mm	D mm	Mounting Detail		Weight kg.
					X	Y	
GUBC34	250	200	200	153	215	217	5.4
GUBSC4	400	255	291	174	217	260	9.8

Dimensions shown are within manufacturing tolerance

Both 250 and 400 watt floodlights have the same construction and dimensions as shown.

Incandescent and blended lamps do not need a separate power unit enclosure.

For discharge lamps two types of aluminium enclosure is used, as power unit, to accommodate the ballast and starter:

1. GUBC34 for 250 watt Floodlight
2. GUBSC4 for 400 watt Floodlight

Both power units may be supplied separate to floodlight, electrically connected by cable and gland, as shown above left.

For 250 watt floodlights, the power unit can also be mounted on floodlight body, as shown above right. For 400 watt the power unit can not be mounted on the floodlight.



Marking to ATEX 94/9/EC Directive: II 2 G Ex d IIC T4 or T3 Gb / II 2 D Ex tb IIIC T126°C or T141°C Db IP66

Zone: 1, 2, 21, 22 , Gas Group IIC

Compliance with: IEC 60079-0, IEC 60079-1, IEC 60079-31

EC Type Examination Certificate: ISSeP 09 ATEX 012

Production quality assurance notification: ITS18ATEXQ03386

IECEx Quality Assessment Report: GB/ITS/QAR18.0003/00



FEATURES

- Enclosure:** Copper free aluminium alloy suitable for petroleum and marine locations.
- Glass:** Heat and impact resistant tempered glass sealed onto a threaded metal base.
- Lamp:** LED module, 20 to 120 W.
- Reflector:** Built in aluminium reflector supplied as standard.
- IP rating:** IP66 to IEC 529 / EN 60529.
- Installation:** Designed to be installed and rotate in any horizontal or vertical direction.
- Cable entry:** ISO 965.1 metric as standard. NPT or other threads supplied on request.
- Earthing:** Standard M6 internal and external earth screws.
- Finish:** Electrostatic powder coated or two pack epoxy paint.



OPTIONS

Cable gland

نور محور فارس
تولید کننده تجهیزات الکتریکی ضد انفجار
NM SWITCHGEAR
Explosion Proof Electrical Supplies



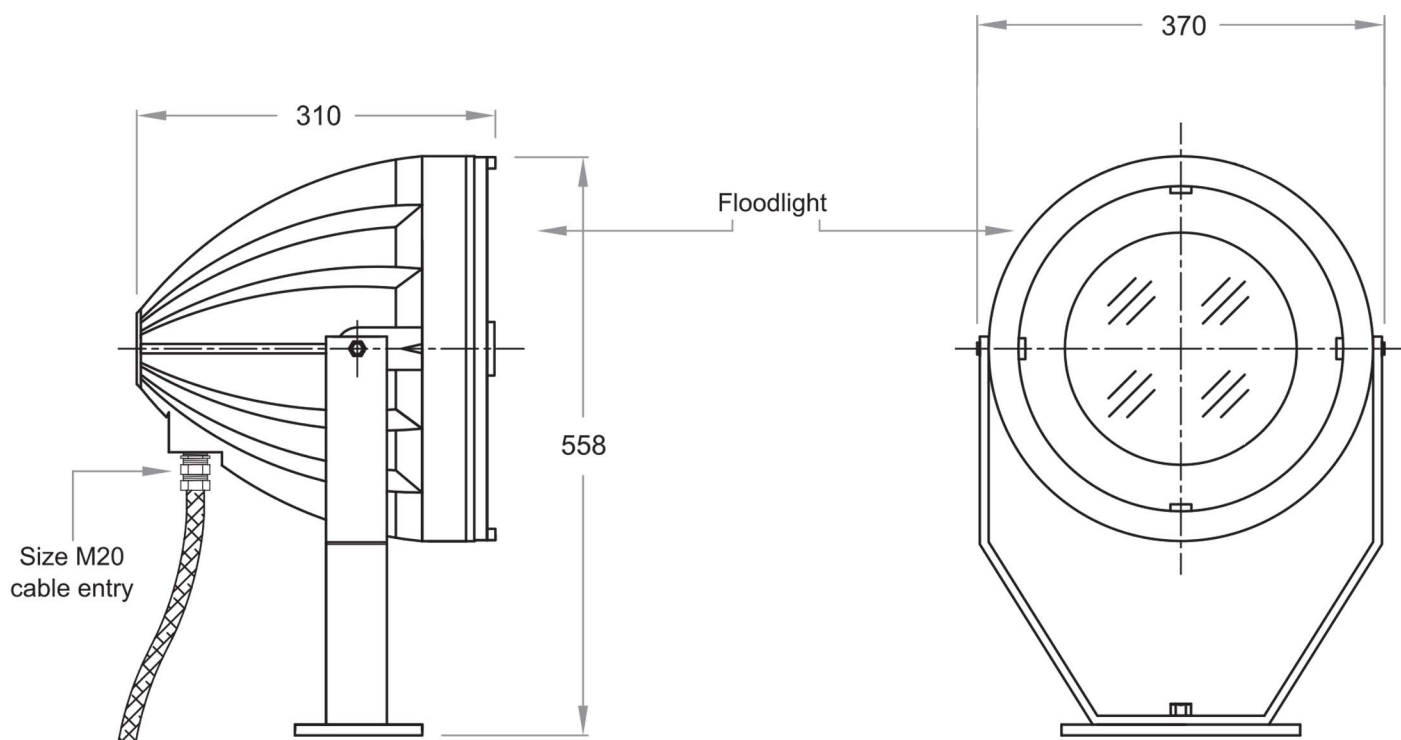

Dimensions shown are within manufacturing tolerances.

Floodlight weight: 22 KG.

All dimensions are in mm.

TYPE	RATING	LUMENS
NMFL	20W	1840
NMFL	40W	3680
NMFL	70W	6400
NMFL	100W	9000
NMFL	150W	13000
NMFL	200W	18500